

Air Circulator Owner's Manual

Circulateur d'air Manuel d'emploi

Model:
FC-100, FC-300, FC-420

(220-240V~,50HZ)

R Lisez et gadez ces instructions



Read and save these instructions
www.xpower.com | www.tx-5.com.hk

Safety Instructions

WARNING - READ AND SAVE THIS INSTRUCTIONS BEFORE USING THIS PRODUCT.

The user of electrical products may create hazards that include, but are not limited to injury, fire, electrical shock. Failure to follow these instructions may damage and/or impair its operation and void the warranty.

- Before operating, remove all packaging material and check for any damage that may have occurred during shipping or any missing items.
- Check household power supply to ensure it matches the appliance's specification.
- **DO NOT** operate any fan with a damaged cord or plug. Discard fan or return it to an authorized service facility for examination and/or repair.
- **DO NOT** run cord under carpeting. **DO NOT** cover cord with throw rugs, runners, or similar coverings. **DO NOT** route cord under furniture or appliances. Arrange cord away from traffic area and where it will not be tripped over.
- To reduce the risk of fire or electric shock, **DO NOT** use this fan with any solid-state speed control device.
- **DO NOT** touch this appliance or the plug with wet hands or while standing in water.
- **DO NOT** operate the appliance in any pooled water.
- **DO NOT** use the product in areas where gasoline, paint or other flammable goods and objects are used or stored.
- **DO NOT** insert or allow objects to enter any ventilation or exhaust opening as this may damage the appliance and void the warranty.
- **DO NOT** cover the air inlet or outlet on the appliance.
- **DO NOT** direct the air flow at human faces or bodies.
- **DO NOT** allow children to play with this appliance.
- **AUTOMATICALLY OPERATED DEVICE** – To reduce the risk of injury, disconnect from power supply before servicing.
- Remove the power cord from the electrical receptacle by grasping and pulling on the power cord plug-end only, **DO NOT** pull the cord directly.
- **DO NOT** attempt to repair or adjust any electrical or mechanical functions of this appliance, as this may cause danger and void the warranty.
- If the appliance is damaged or it malfunctions, **DO NOT** continue to use it. Unplug the product from the electrical outlet. Refer to troubleshooting guide or contact XPOWER.
- Store in a dry area, away from exposure to sunlight, extreme temperature and humidity, or other extreme environments, when not in use.
- For model FC-100, **DO NOT** stack more than six units of this appliance.
For model FC-300, **DO NOT** stack more than five units of this appliance.

Items Included

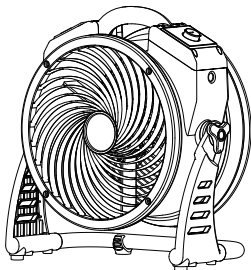

- Air Circulator x 1*



- Rubber Washer
x 2**

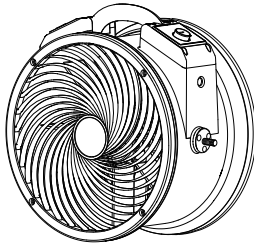

- Air Circulator
Body x 1**



- Rack Handle x 2**

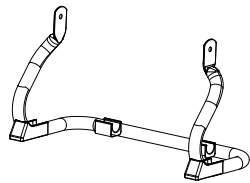

- Rack x 1**



- Owner's Manual x 1

* For model FC-100/FC-420.

The exact appearance of the products might be slightly different from the diagram.

** For model FC-300 only.

Parts Description

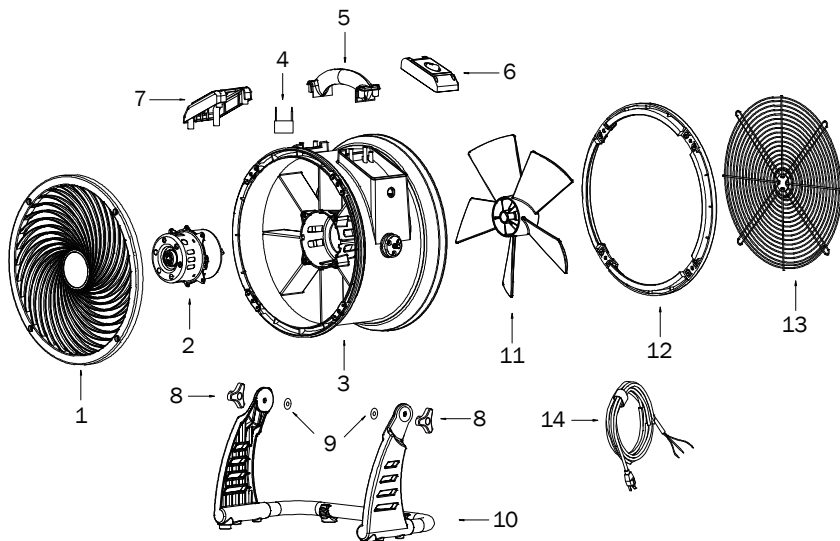

Parts Description (Continued)

- | | | |
|---------------------------|---------------------------|------------------------|
| (1) Front Grille Cover | and Timer Plate** | (10) Rack |
| (2) Motor | (7) Additional Electrical | (11) Fan |
| (3) Housing | Receptacle *** / Timer | (12) Rear End Cover |
| (4) Capacitor | Plate **** | (13) Rear Grille Cover |
| (5) Housing Handle | (8) Rack Handle | (14) Power Cord |
| (6) Switch Plate*/ Switch | (9) Rubber Washer | |

* / ** / *** / **** These functions do not apply all models mentioned in this manual.
(See Page 8: Technical Specification)

Air Circulator Introduction

- XPOWER Air Circulators are designed to offer efficient air circulation and ventilation with its high and long-distance focused airflow.
- It's perfect for air circulation and ventilation in janitorial/sanitation jobs, air condition control and more.

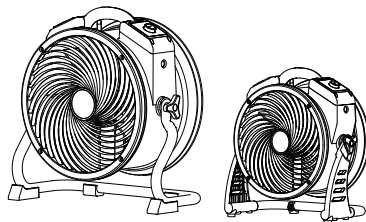

Installation and Operation Guide

Installing the Rack*

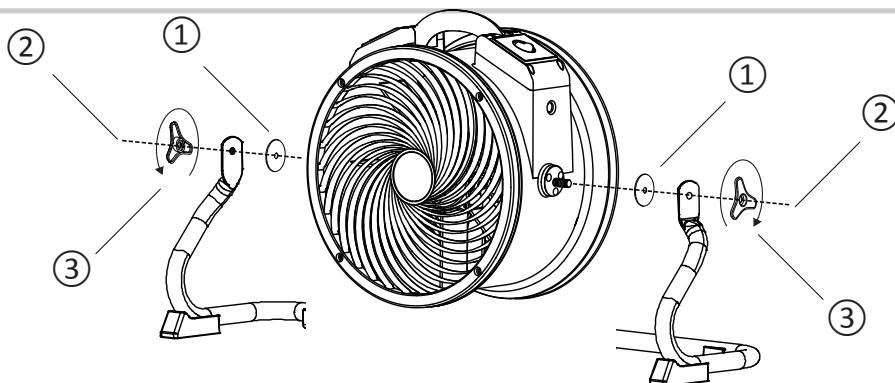

- ① Fit both rubber washers onto bolts on both sides of unit.
- ② Align the rack onto the air circulator.
- ③ Fasten the connection with the rack handle.

* For model FC-300 only.

Installation and Operation Guide(Continued)

Switch Plate

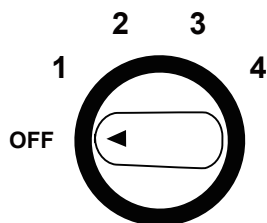

Four Speed Control

For model FC-100/FC-200/FC-300 only

- Turn to “**OFF**” position to switch the machine OFF. Turn to any speed position to switch the machine ON.
- Turn clockwise to set the desired speed. There are 4 speeds from: **4, 3, 2, 1**. “**4**” is the highest speed and “**1**” is the lowest speed .

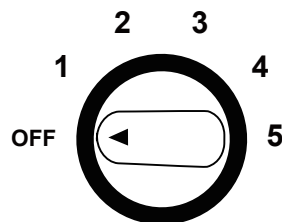

Five Speed Control

For model FC-420 only

- Turn to “**OFF**” position to switch the machine OFF. Turn to any speed position to switch the machine ON.
- Turn clockwise to set the desired speed. There are 5 speeds from:**5, 4, 3, 2, 1**.”**5**” is the highest speed and “**1**” is the lowest speed.

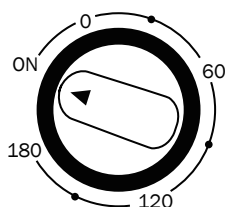

Timer Switch

- Turn clockwise to set timer for minutes count down to an automatic stop.
- The timer can be set for up to 180 minutes (3 hours).
- When the timer reaches “**0**” position, the unit stops working. On “**ON**” position, it will work constantly.

Installation and Operation Guide(Continued)

Adjust Operation Position

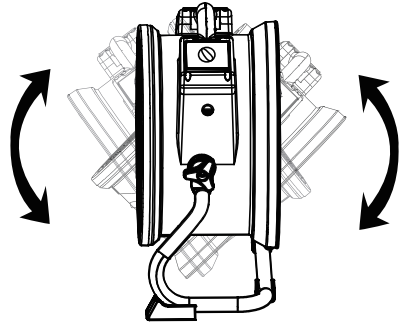
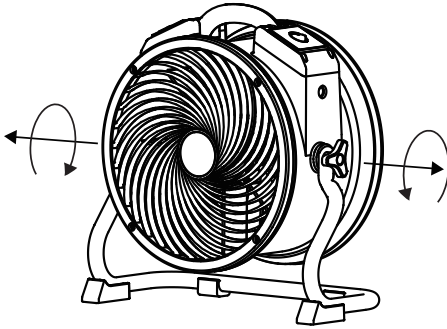

- The Air Circulator features 360° Rotation. Tilt Air Circulator to desired angle and screw on rack handles to secure the position.

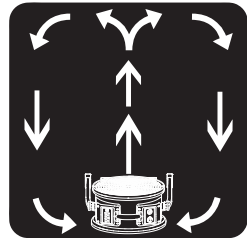
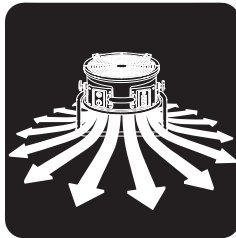
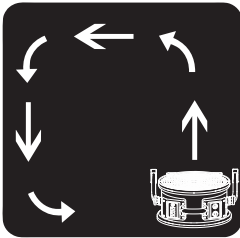

Transportation

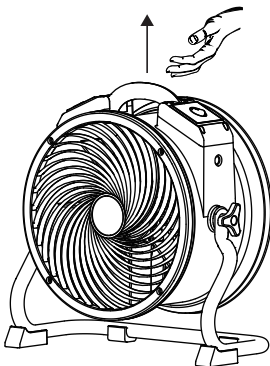

Lift with Handle

- Lift the Air Circulator with the handle on the top.

User Maintenance Instructions

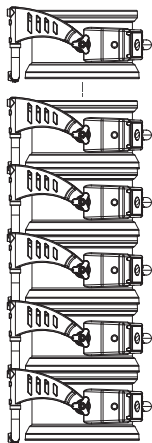

Stack Multiple Units

- Stack the Air Circulators on the sides. Align the air inlets of both Air Circulators.

WARNING

- For model FC-100, **DO NOT** stack more than six units of this appliance.
- For model FC-300, **DO NOT** stack more than five units of this appliance.
- Stacking function is not secure during transportation.

Troubleshooting Guide

PROBLEM	POSSIBLE CAUSE	SOLUTION
Air Circulator does not start	No electricity.	Check for power supply.
	The power cord is not properly plugged in.	Remove and reconnect the power cord.
	The timer switch is set to “0” position.	Set the timer switch to “ON” position.
Unit runs but the speed is abnormal	Air inlet or air outlet is blocked.	Remove blockage.

If troubleshooting does not resolve your problem, please contact XPOWER or other parties authorized by XPOWER for further instructions.

Technical Specification

MODEL NUMBER	FC-100	FC-300	FC-420
Voltage/ Frequency	200-240V~,50 Hz		
Motor Power	60 W	100W	200W
Speed Control	4 Speeds		
Timer	3 Hours (OFF)		
Cord Length	1.8 m	3.0 m	4.5 m
Housing	PP		ABS
Unit Dimension (L) x (W) x (H)	39.0 x 37.0 x 23.5 cm	47.2 x 48.8 x 23.9 cm	55.6 x 24.9 x 57.1 cm
Unit Weight	4.1 kg	5.5 kg	10.6 kg
Safety Certification	CE		

If your product(s) is not listed above, please visit www.xpowermfr.com for more information.

XPOWER LIMITED WARRANTY

XPOWER warrants this product to be free from defects in material and workmanship for a period of one (1) year from the date of original purchase.

The liability of XPOWER is limited solely to the cost of the repair or replacement of parts/the unit at XPOWER's discretion.

Important!

This warranty does not cover or apply to defects due directly or indirectly to misuse, abuse, disassembly, alteration, corrosive chemicals, improper voltage, fire, flood, negligence, accident, improperly or incorrectly performed maintenance or repair, or failure to perform necessary maintenance or repair, or if the use of this product is not in compliance with the instructions and specifications for its use.

The POWER CORD is not covered by the warranty.

Service

Contact an XPOWER Distributor in your region for warranty service and parts replacement.



XPOWER Manufacture, INC.

668 S. 6th Ave.,
City of Industry, CA 91746 USA

Read and save these instructions
www.xpower.com | www.tx-5.com.hk
